

# **GARDMAN** 19043 Rippling Vase Indoor Water Feature

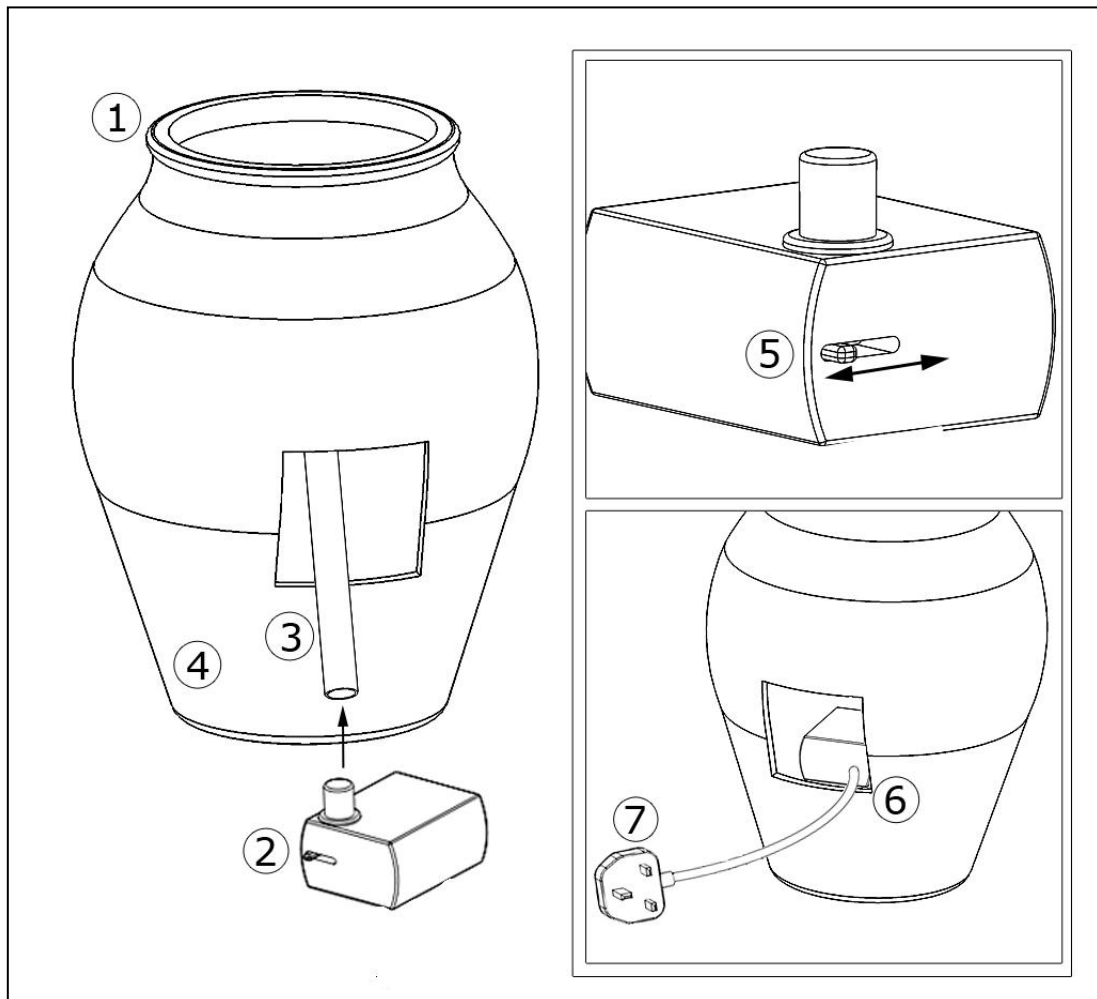

Please read the assembly instructions and separate pump instructions carefully prior to installation.

## **Assembly Instructions**

- Unpack all the water feature components from the packaging and lie on a flat surface.
- Take the feature (1) and attach the pump (3) to the rubber tube (2) that is located on the back, and then lay the pump inside on the base of the feature (4). Make sure the tube is properly connected and is not kinked.
- The pump flow can be adjusted with the switch (5) which is located on the inlet of the pump.
- Position the cable through the reservoir opening located (6) on the back of the water feature. Do not insert the plug (7) in to the mains at this time.
- Fill the reservoir with water to 1.5cm (1/2") from the top. We recommend using warm water to prevent mineral build up.
- Insert the plug/transformer in to the power socket and switch on. If installed correctly water will start to flow from the feature. Please note: On first use, there may be air in the pump and it may take a few moments for the water to come through.



# 19043 Rippling Vase Indoor Water Feature

## Care & Cleaning

- Clean the feature in a mixture of vinegar and water to remove any mineral build up.
- Always turn your water feature off if leaving your home for a sustained period of time.

## Troubleshooting

**Note: Always switch off and disconnect the plug/transformer from the electrical outlet before handling the pump.**

**1) If the pump starts to lose power or fails to operate, check the following;**

- a) Check if sufficient water is inside the reservoir.
- b) Check the pump and tubing for any obstructions.
- c) Check the fuse in the plug or try a different power outlet to make sure the pump is receiving electrical power.
- d) Remove the pump inlet cover to access the impeller area. Turn the rotor gently to ensure it is not broken or jammed (please revert to your separate pump instructions for further information).

**2) If the pump gurgles or spews;**

- a) Check the water level to make sure the pump has enough water to function and ensure the water in the water reservoir is always at the correct level.

**3) If water is splashing outside the fountain or the pump is running with slow water circulation check the following;**

- a) Adjust the flow control switch located on the inlet of the pump accordingly for a more suitable flow rate.
- b) Make sure the pump is completely submersed in water.



# 19043 Rippling Vase Indoor Water Feature

## Important safety instructions

Always unplug the appliance from the electrical outlet after using and before cleaning.

Do not drop or place the feature in water or other liquids.

Do not connect to any voltage other than that shown on the plug/transformer.

Never connect the pump directly in to a mains supply without the use of the step down plug/transformer.

Never cover the water feature when it is in operation.

To get the best water flowing effect, the water feature should be placed on a flat surface.

Never place the water feature on top of another electrical appliance.

Never let the pump run dry as this will shorten the life of the pump.

Use mains water only when filling the water feature.

Retain instructions for future reference. If in any doubt a qualified electrician should be consulted.

### ROHS/Directive 2002/95/EC

The crossed out Wheelie bin symbol on the product, the document or the packaging accompanying the product, indicates that this appliance/fitting must not be treated as household waste. It should be handed over to the applicable collection point for the recycling of electrical and electronic equipment. Disposal must be carried out in accordance with local environmental regulations for waste disposal. For more detailed information about treatment, recovery and recycling of this product, please contact your local authority, your household waste disposal service or retailer where you purchased the product.

### WEE Directive 2002/196/ECU

This appliance/fitting is marked according to the European Directive 2002/196/ECU on Waste Electrical and Electronic Equipment (WEEE). By ensuring this product is disposed of correctly, you will help prevent potentially negative consequences for the environment and human health, which could otherwise be caused by inappropriate waste handling.

Add CE, ROHS, WEE, EMC logo's



# 19043 Rippling Vase Indoor Water Feature

## PROOF OF PURCHASE

In the event of your water feature requiring spare parts or servicing you will need to submit the completed form below along with your proof of purchase.

Date of Purchase:

Place of Purchase (Retailer):

Purchase Price:

Enclose Your Purchase Receipt Here:

Retailer Address:

### Customer Information

Thank you for your purchase of this Gardman water feature. The water feature is guaranteed for one year. If you have any problems or queries with this water feature then please contact our helpline number: 01406 372227 or write to: Gardman Ltd, High Street, Moulton, Spalding, Lincs, PE12 6QD. Fax: +44 (0)1406 372233

Pump replacements are available from Gardman directly so call on +44 (0) 1406 372227 for further assistance