

PERMANENT YET HARMLESS PROTECTION

GARDMAN

Mole-Gard

How does it work?

When installed Mole-Gard emits a sonic frequency that creates a wave of vibration every 10 to 15 seconds.

How large an area will it cover?

Mole-Gard will cover an unobstructed area of up to 1000 sq. meters depending on soil conditions. The heavier the soil the larger the area of coverage. The area may be reduced to 500 sq meters when placed in light sandy soil.

Instructions for use

Unscrew the top (*anti-clockwise*) and insert 4 x 1.5V D size batteries (*not supplied*). Replace cap (*do not over tighten*) this is a bayonet fitting not a screw top. Make a hole and place the unit in the ground so that it fits snugly to the level of the top mark on the unit approx. 7 cms. from the top of the unit.

Do not force or hammer the unit.

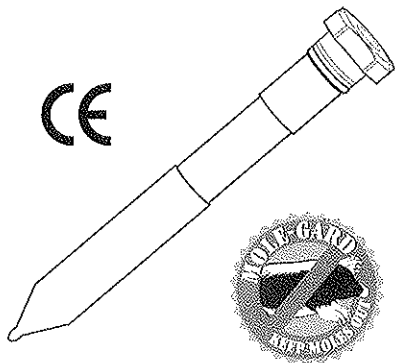
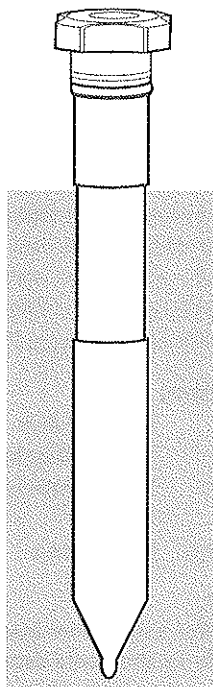
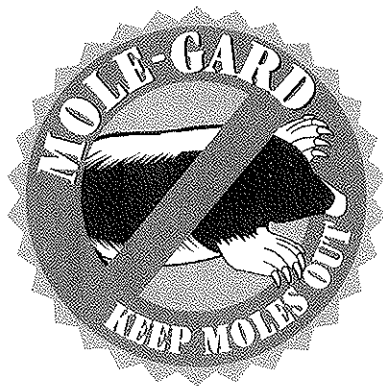

GARDMAN

**Gardman Ltd, High Street,
Moulton, Spalding, Lincs, PE12 6QD
Telephone 01438 727183**

Operating Instructions

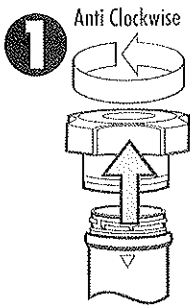

1. To open your Mole-Gard unscrew the top (*anti clockwise*) by a quarter turn. The top is held in with a bayonet style fitting.

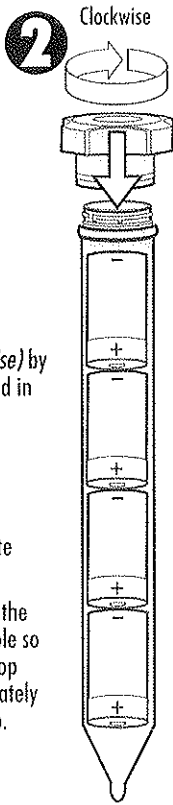

2. Insert the 4 x 1.5V D cell batteries (*not supplied*), and Replace the cap (*clockwise*).

3. Mole-Gard will now vibrate within 15 seconds.

4. Insert the Mole-Gard into the ground in a pre-prepared hole so that it fits snugly. Up to the top mark on the body, approximately 7 cms from the top of the cap.

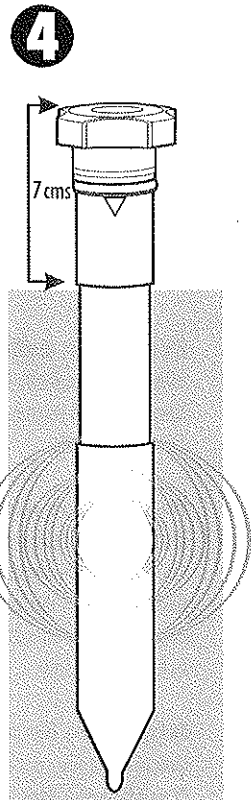
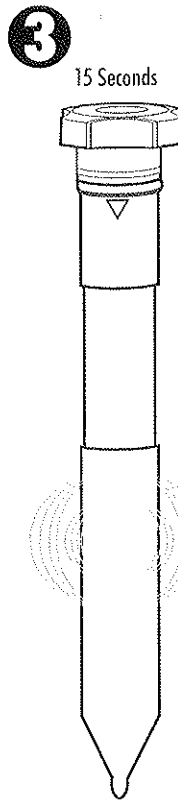

Soil Conditions:

The area of coverage will vary dependant upon the type of soil in which your Mole-Gard is to be used. A heavy soil will produce the best results of over 1000 square meters being covered. A light sandy soil will reduce the effective range by up to 50%.

Specifications:

Dimensions: 37.5cms x 5.8cms
 Weight: 190gms without batteries
 Power supply: 1.5V (4xD batteries)
 Frequency: 300Hz
 Effective Range: 1000 Sq meters

Important

Make a pilot hole before inserting Mole-Gard into hard ground. Do not hammer or push excessively as this could damage the unit.

Do not expect an instant reaction. Mole-Gard must be used continuously for seven days before the moles will start to leave the area.

When the unit is first used an increase in mole activity is quite common.

GARDMAN Mole-Gard

Mole-Gard will cover up to 1000 sq meters of unobstructed land

It will operate in a circular pattern, approx 36 meters in diameter